

5229  
 28 99 S  
 109/20 328 S  
 60 355 S  
 47 388 N  
 48 394 N  
 150 389 N  
 38 394 N  
 18 388 N

Black Oak on  
 Juniata The  
 Courses down some

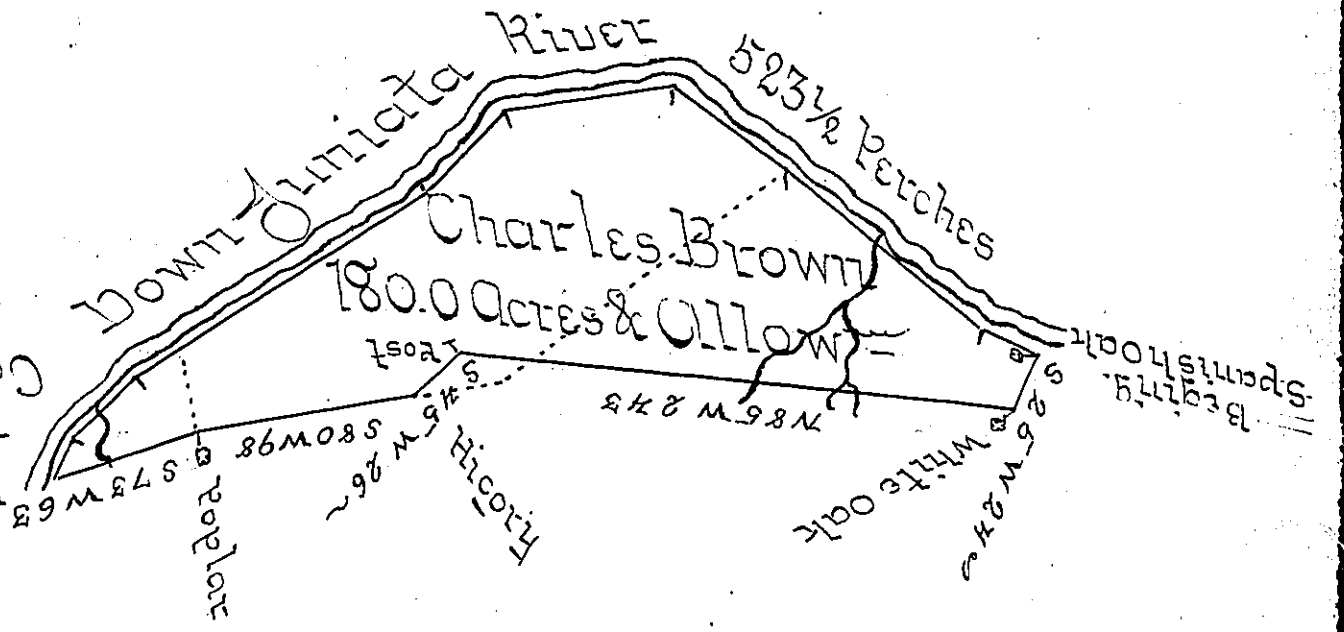

Foot of the Muscatora Mountain

The Draught of a Tract of Land called the Noisy Entry situate on the South Side of Juniata and joining the foot of the Muscatora Mountain containing One Hundred & Eighty Acres ~~with~~ With the usual Allowance of six Acres & Cent for Roads Surveyed the 14<sup>th</sup> day of April Anno Dom: 1767 For Charles Brown in Pursuance of an Order of Survey No 55 Bearing date at Philad: the first day of August Anno Dom: 1766 agreeable to the Determination of the Board of Property dated the 29<sup>th</sup> day of December Anno Dom: 1766

To John Lukens Esq: S. J. } Wm Macclay U.S.  
 of Pennsylvania

As the Order of the first of May 1767 for restricting Surveys to the Exact Quantity &c<sup>o</sup> was not come to hand when the above was made W.M.

The above Measures made By Wm Macclay

IN TESTIMONY that the above is a copy of the original remaining on file in the Department of Internal Affairs of Pennsylvania, made conformably to an Act of Assembly approved the 16th day of February, 1833, I have hereunto set my Hand and caused the Seal of said Department to be affixed at Harrisburg, this sixth day of JULY 1903.

*James P. [Signature]*  
 Secretary of Internal Affairs.